

Description

- Fast Acting fuse for ESS/Charging
- 1500Vdc ideal for ESS or Charging application
- Excellent DC performance

Specifications

Ordering P/N	Rated Current (A)	Rated Voltage	Breaking Capacity	I ² t		1.0In Power loss (W)
				Pre-Arcing	Total @1500Vdc	
ST7515X-400	400	1500VDC	100kA	36000	117500	165
ST7515X-450	450			51500	164500	178
ST7515X-500	500			69500	219500	195
ST7515X-550	550			87200	270500	210
ST7515X-630	630			123000	372500	236
ST7515X-700	700			171000	505000	257
ST7515X-800	800			266000	758500	268
ST7515X-900	900			384000	1056500	287
ST7515X-1000	1000			517000	1370800	338

Dimension (mm)

Type: ST7515D-xxx

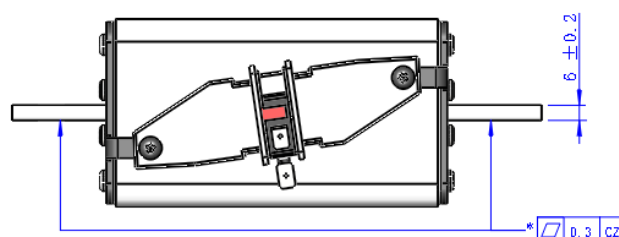
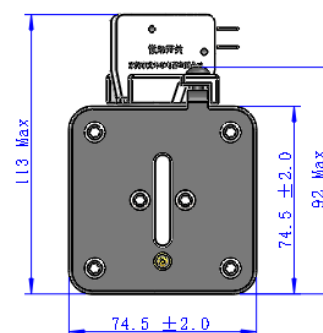
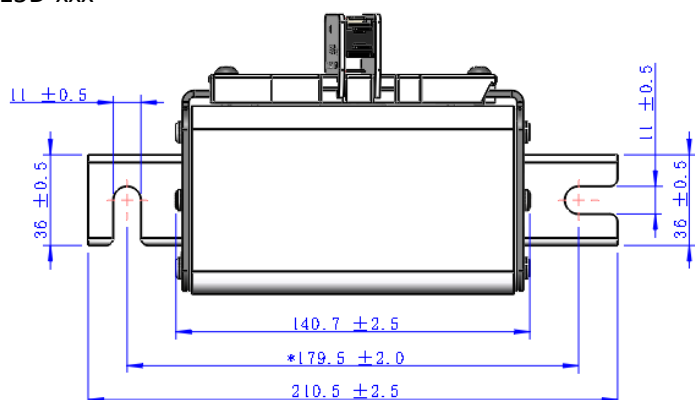

Type: ST7515U-xxx

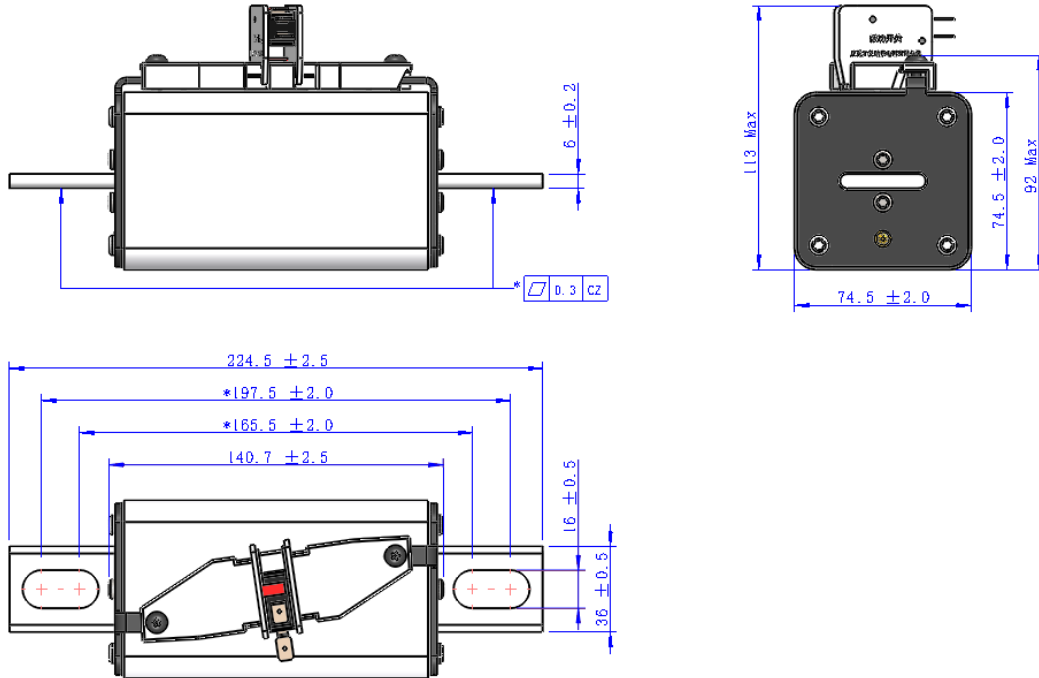

Type: ST7515F-xxx

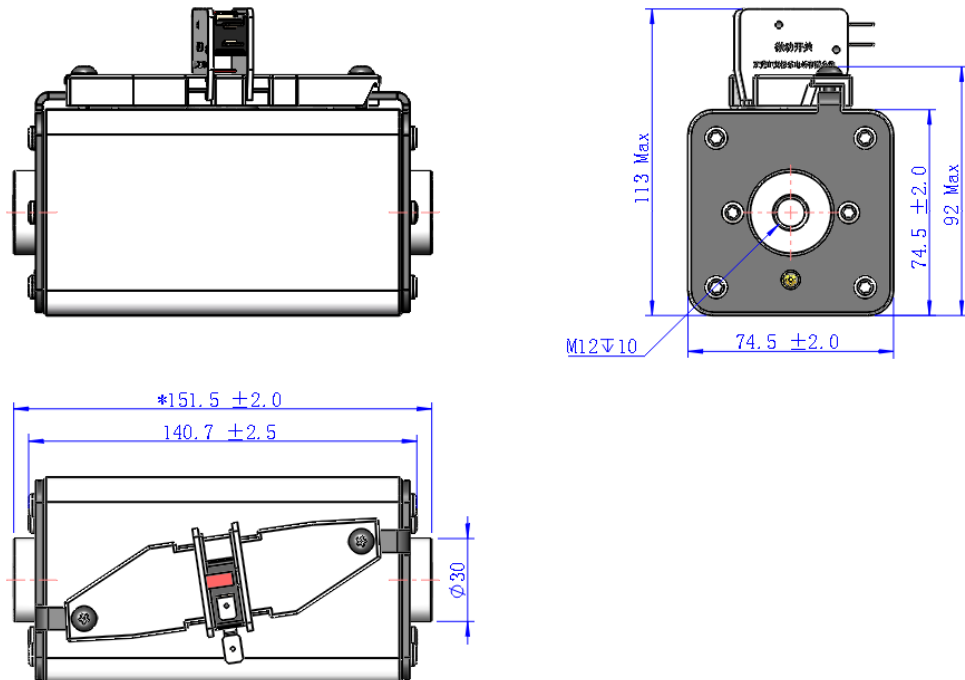

Time-Current Curve

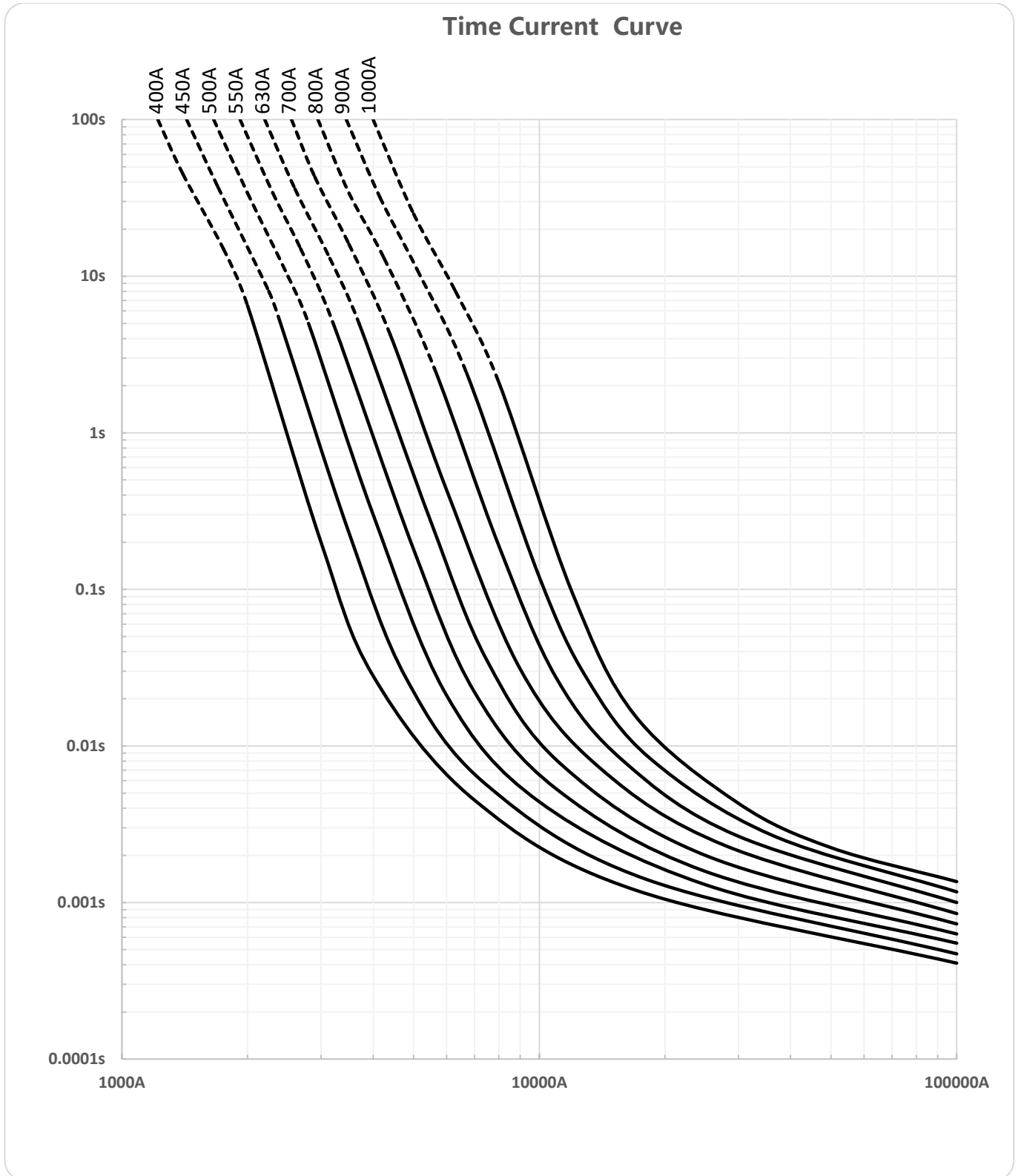

Transportation and Storage

During transportation and storage, should avoid water seepage and mechanical damage

Conditions for operation in service

Where the following conditions apply, fuses complying with this standard are deemed capable of operating satisfactorily without further qualification.

Normal temperature: -5°C to 40°C ;

The altitude of the site of installation of the fuses does not exceed 2 000 m above sea level;

The air is clean and its relative humidity does not exceed 50 % at the maximum temperature of 40°C ;

Higher relative humidities are permitted at lower temperatures, e.g. 90 % at 20°C ;

Under these conditions, moderate condensation may occasionally occur due to variation in temperature.

For operation condition other than above, please contact manufacturer.

Temperature Derating Curve

Operating Temperature: -40°C to $+125^{\circ}\text{C}$, with proper derating factor applied

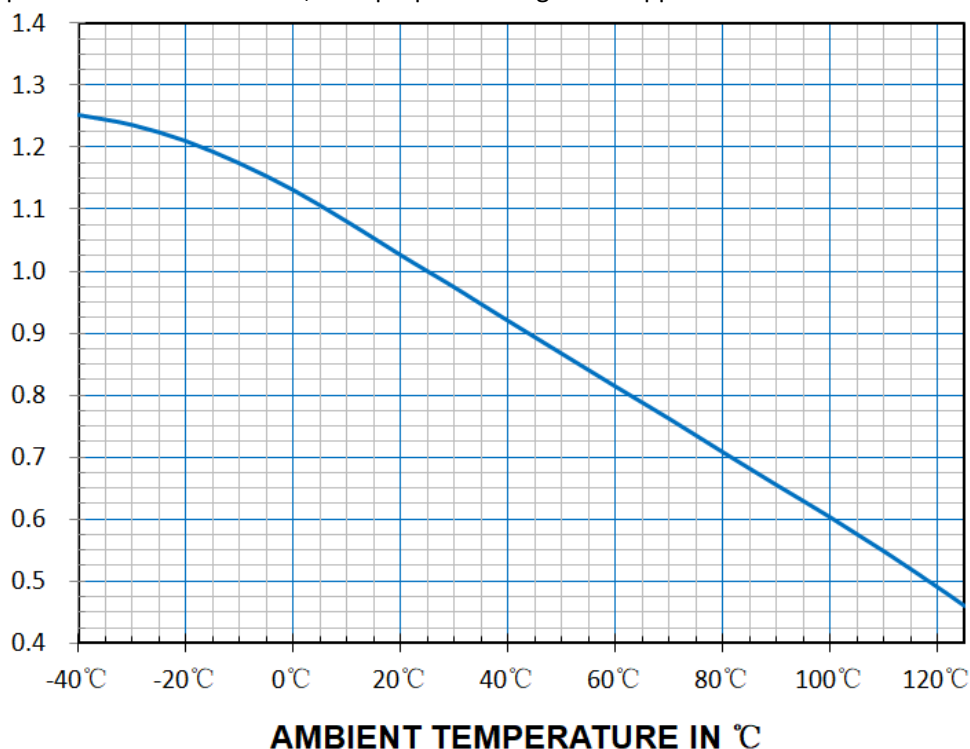

Re-rating with High altitude

$$I = I_n * (1 - (h - 2000) / 100 * (0.5 / 100)), 5000$$

