

# Electric Vehicle PowerFuses

## 500VDC, 450A ~ 700A

### Description

- Fast Acting fuse for EV/HEV
- 500Vdc ideal for EV or HEV application
- Excellent DC performance

### Specifications

Ordering P/N	Rated Current (A)	Rated Voltage (VDC)	Breaking Capacity (A)	0.5In Power loss 0.5 (W)
ST4304-450 N	450	500	20000	<15
ST4304-500 N	500	500	20000	<18
ST4304-630 N	630	500	20000	<22
ST4304-700 N	700	500	20000	<27

\*Temperature Rise : <50K with 50% of rated current

### Dimension (mm)

Type:Single

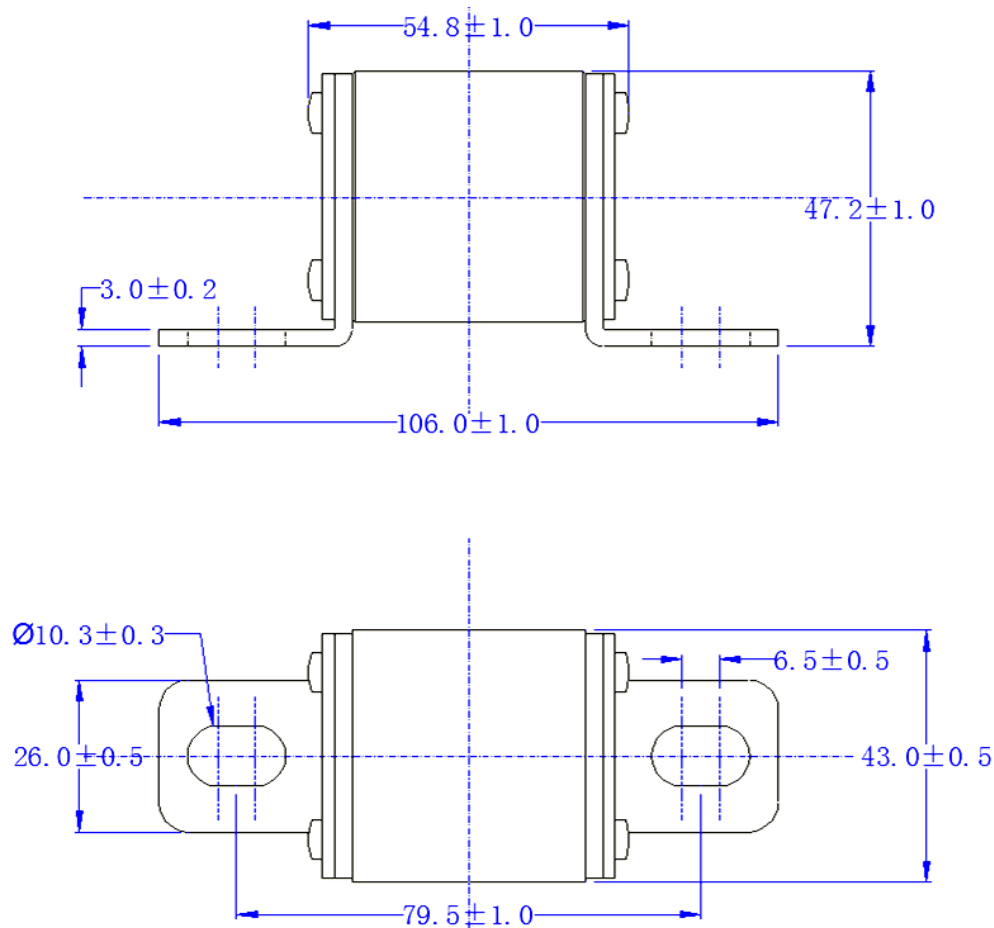

**DC Fuse for EV/HEV**

# Electric Vehicle PowerFuses

500VDC, 450A ~ 700A

## Time-Current Curve

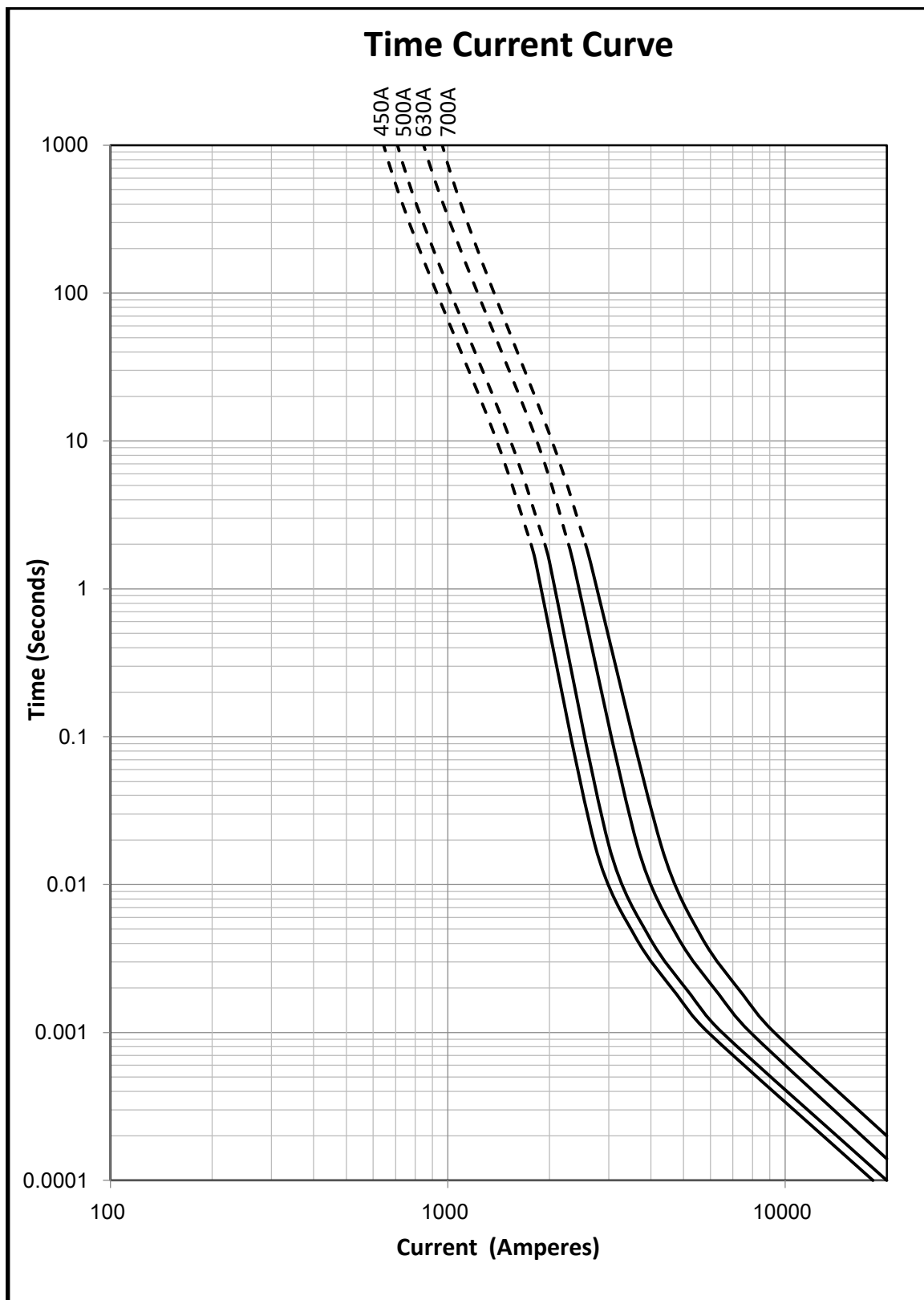

**DC Fuse for EV/HEV**

# Electric Vehicle PowerFuses

## 500VDC, 450A ~ 700A

### Transportation and Storage

During transportation and storage, should avoid water seepage and mechanical damage

### Conditions for operation in service

Where the following conditions apply, fuses complying with this standard are deemed capable of operating satisfactorily without further qualification.

Normal temperature: -5°C to 40°C;

The altitude of the site of installation of the fuses does not exceed 2 000 m above sea level;

The air is clean and its relative humidity does not exceed 50 % at the maximum temperature of 40°C;

Higher relative humidities are permitted at lower temperatures, e.g. 90 % at 20°C;

Under these conditions, moderate condensation may occasionally occur due to variation in temperature.

For operation condition other than above, please contact manufacturer.

### Vibration

Meet JASO D622:2006 Section 6.3.3 Vibration durability test requirement, can be use on Electrical Vehicle application

### Temperature Re-Rating Curve

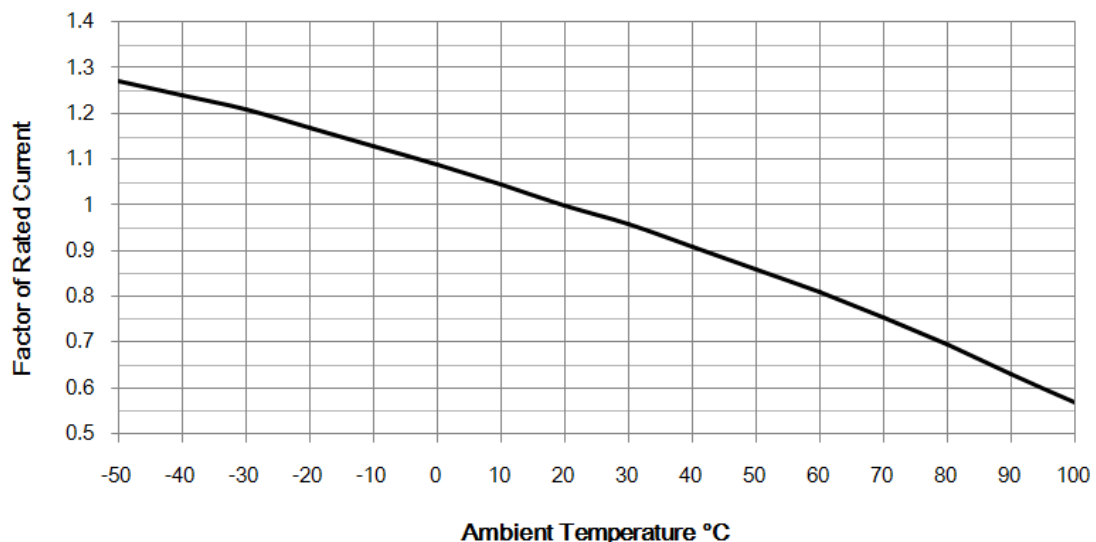

**DC Fuse for EV/HEV**