

# Electric vehicle auxiliary fuses

## 200VDC, 5A ~ 60A

### Description

- General purpose fuse for EV/HEV
- Stud-mount, optional for other installation
- 200Vdc ideal for EV or HEV application
- Excellent DC performance
- Design refer to JASO D622:2006

Electrical Characteristics		
% of Ampere Rating (A)	Operating	
	Min	Max
200%	1	300
300%	0.2	30
500%	0.1	10

### Ordering PN Description

ST100201 - 15 AP

Series No.  
系列号

AMP.  
电流数

Assembly Code  
安装方式

#### Assembly code

'AP' means center terminal bolt installation

'BP' means bottom terminal bolt installation

### Specifications

Type	Ordering P/N	Electrical Characteristics	
		Rated Current (Amp)	Interrupting rating
Single/	ST100201-5YY	5	200Vdc/15000A
	ST100201-6YY	6	
	ST100201-8YY	8	
	ST100201-10YY	10	
	ST100201-15YY	15	
	ST100201-20YY	20	
	ST100201-25YY	25	
	ST100201-30YY	30	
	ST100201-35YY	35	
	ST100201-40YY	40	
	ST100201-50YY	50	
	ST100201-60YY	60	

\*Temperature Rise : <=75K with rated current  
<=45K with 60% of rated current

## DC Fuse for EV/HEV

# Electric vehicle auxiliary fuses

## 200VDC, 5A ~ 60A

### Dimension (mm)

Assembly Code 'AP'

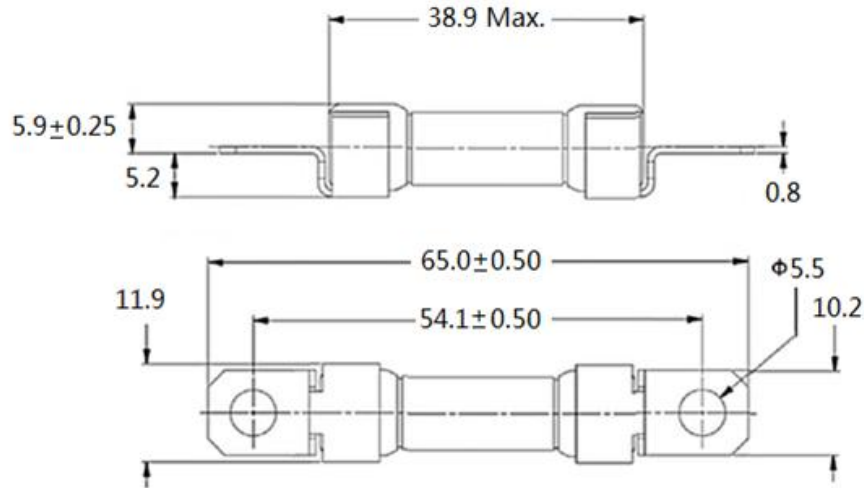

Assembly Code 'BP'

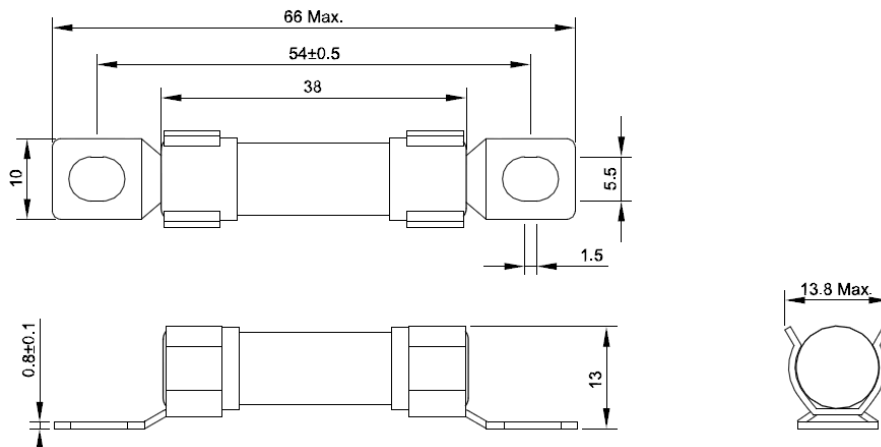

Note: For AP & BP, recommend tightening torque is 4.5+/-1.0Nm

# Electric vehicle auxiliary fuses

## 200VDC, 5A ~ 60A

### Package

AP: 20pcs ; BP: 16pcs

ST100201-xxAP:



ST100201-xxBP:



# Electric vehicle auxiliary fuses

## 200VDC, 5A ~ 60A

### Time-Current Curve

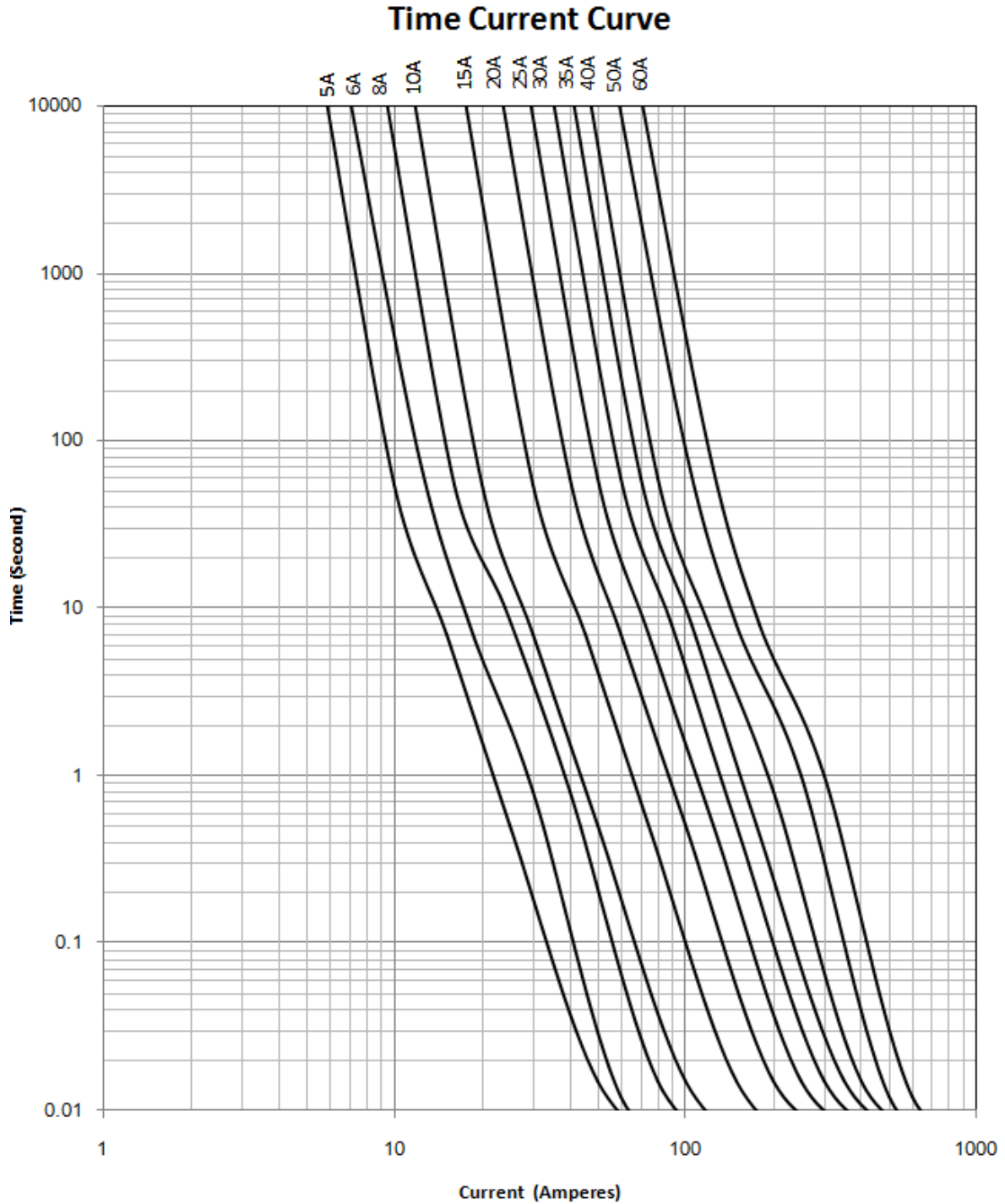

**DC Fuse for EV/HEV**

# Electric vehicle auxiliary fuses

## 200VDC, 5A ~ 60A

### Transportation and Storage

During transportation and storage, should avoid water seepage and mechanical damage

### Conditions for operation in service

Where the following conditions apply, fuses complying with this standard are deemed capable of operating satisfactorily without further qualification.

Normal temperature:  $-5^{\circ}\text{C}$  to  $40^{\circ}\text{C}$ ;

The altitude of the site of installation of the fuses does not exceed 2 000 m above sea level;

The air is clean and its relative humidity does not exceed 50 % at the maximum temperature of  $40^{\circ}\text{C}$ ;

Higher relative humidities are permitted at lower temperatures, e.g. 90 % at  $20^{\circ}\text{C}$ ;

Under these conditions, moderate condensation may occasionally occur due to variation in temperature.

For operation condition other than above, please contact manufacturer.

### Vibration

Meet JASO D622:2006 Section 6.3.3 Vibration durability test requirement, can be use on Electrical Vehicle application

### Temperature Rerating Curve

Operating Temperature:  $-40^{\circ}\text{C}$  to  $+125^{\circ}\text{C}$ , with proper rerating factor applied

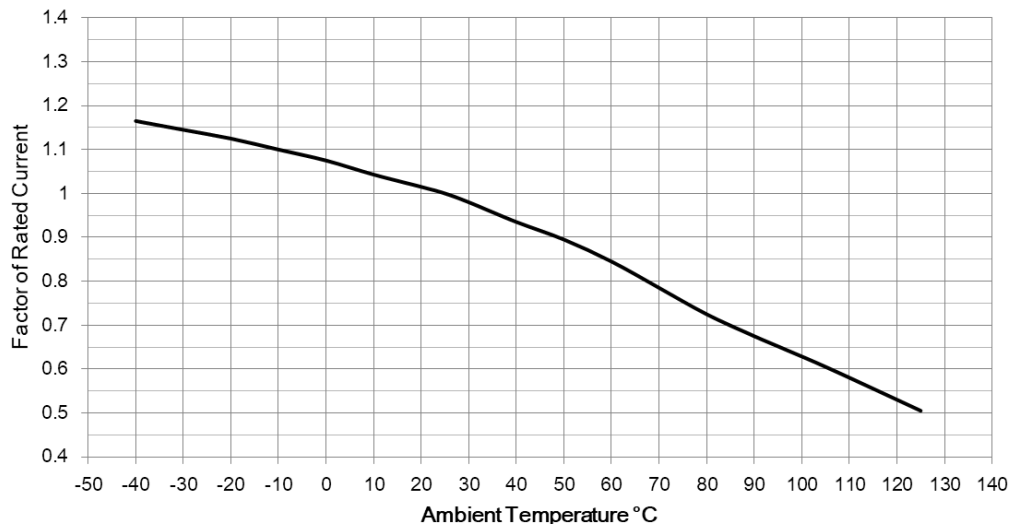

## DC Fuse for EV/HEV